

0710 Series

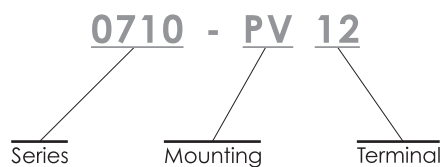

▶ Specification	▶ Outlet
Power Rating	15A 125V AC
Electric Strength	AC 2,000V for 1 Minute
Contact Resistance	30MΩ Max.
Insulation Resistance	100MΩ Min. at 500V DC
Operating Temperature	+65°C
Materials	Thermoplastic UL Flammability 94V-0 & Copper Alloy
Mounting	PV : Snap-In
Terminal	12 : AWG12~14 Wire Application

Unit : mm

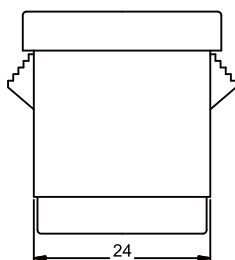
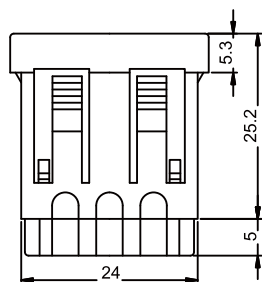
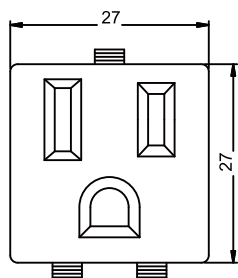

V: SERRATED CLIP

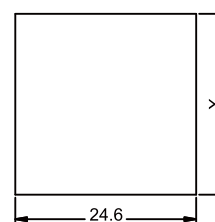

PANEL CUT-OUT