

## VOLTAGE SWITCH

**PART NO : EV-12(A,B,C,D)**

### SPECIFICATION

Contact Rating : 12A 125/250VAC  $\mu$

10(1)A 250V ~  $\mu$  T85 / T55

Contact Resistance : 50 m $\Omega$  MAX

Insulation Resistance : 500 M $\Omega$  (MIN) 500V DC

Dielectric Strength : 2000V AC-1 minute

Electric Life : 300 cycles

Operating Force : 850  $\pm$  300gram



### PART NUMBERING SYSTEM

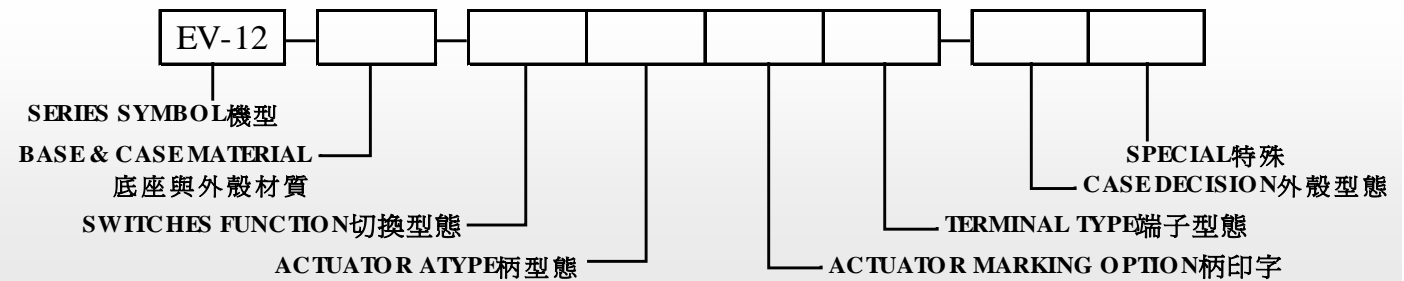

### DIMENSIONS

in mm

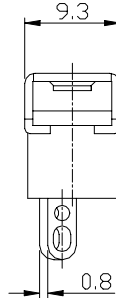
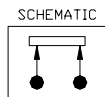
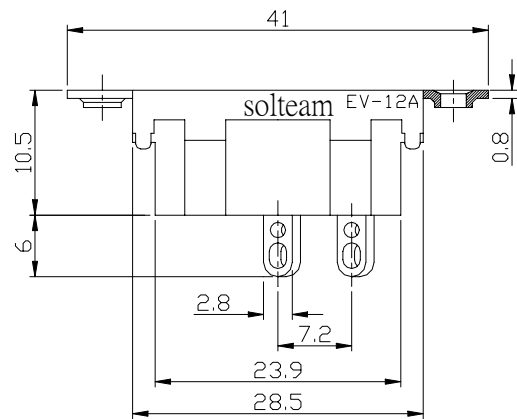
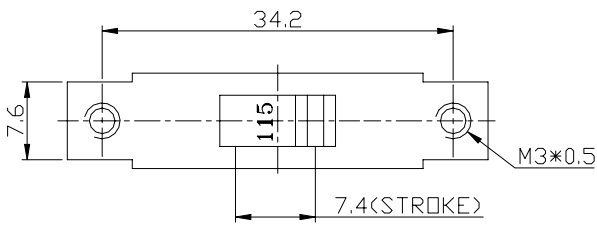

#### ACTUATOR TYPE

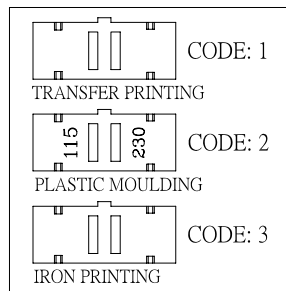

#### ACTUATOR MARKING OPTION

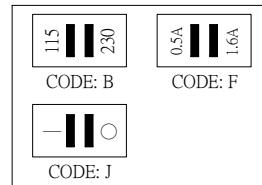

#### TERMINAL TYPE

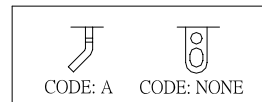

#### SWITCHES FUNCTION

CIRCUIT CODE	POSITION
2	ON NONE OFF
3	ON NONE ON

#### BASE & CASE MATERIAL

CODE	MATERIAL
A	IRON STEM
B	PLASTIC CASE
C	NYLON66 & ISON STEM
D	NYLON66 & PLASTIC CASE

#### CASE DECISION

