

### SPECIFICATION

Contact Rating : 10A 250V AC

15A 250V AC

Insulation Resistance : 100 MΩ (MIN) 500V DC

Dielectric Strength : 2000V AC-1 minute

Operational Temperature : 0~85 °C





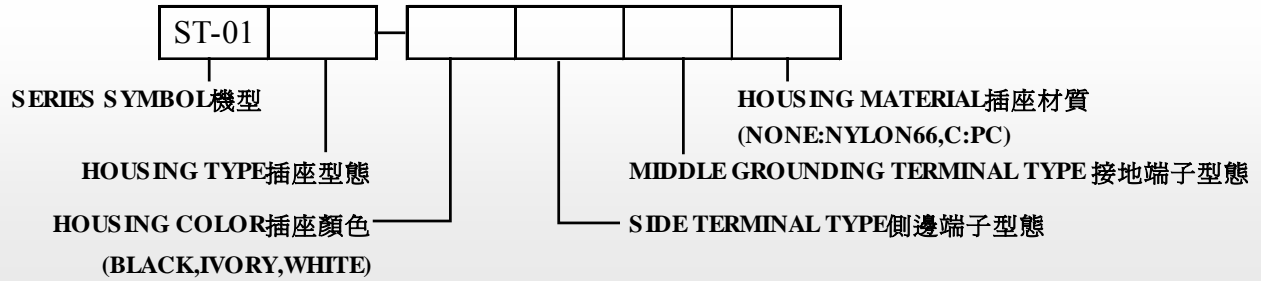

### PART NUMBERING SYSTEM

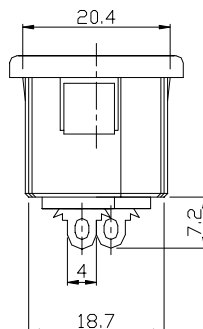
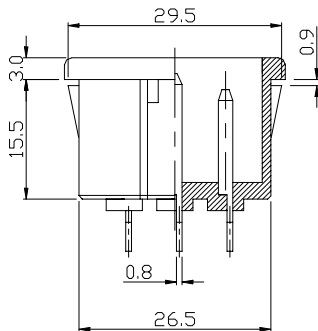
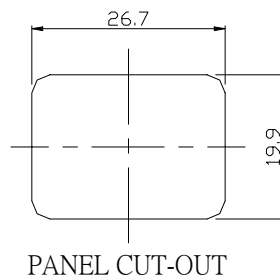
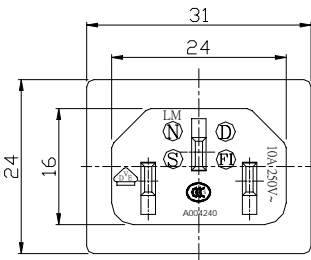

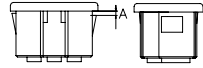
### DIMENSIONS in mm

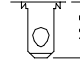

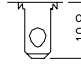
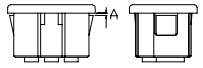
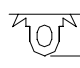
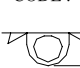
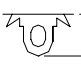
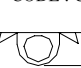
HOUSING TYPE	SIDE TERMINAL TYPE	MIDDLE GROUNDING TERMINAL TYPE										
 <table border="1"> <thead> <tr> <th>CODE</th> <th>AD</th> <th>AK</th> <th>V</th> <th>AB</th> </tr> </thead> <tbody> <tr> <td>A</td> <td>1.5</td> <td>2.0</td> <td>3.0</td> <td>1.5</td> </tr> </tbody> </table>	CODE	AD	AK	V	AB	A	1.5	2.0	3.0	1.5	PLUG-IN 4.7 TERMINAL  7.3 CODE : F  10.8 CODE : AE	PLUG-IN 4.7 TERMINAL  7.3 CODE : 9  10.8 CODE : AV
CODE	AD	AK	V	AB								
A	1.5	2.0	3.0	1.5								
 <table border="1"> <thead> <tr> <th>CODE</th> <th>AU</th> <th>C</th> <th>B</th> <th>BR</th> </tr> </thead> <tbody> <tr> <td>A</td> <td>0.6</td> <td>0.8</td> <td>1.0</td> <td>1.2</td> </tr> </tbody> </table>	CODE	AU	C	B	BR	A	0.6	0.8	1.0	1.2	SOLDER 4.0 TERMINAL  4.5 CODE : W  3.8 CODE : T	SOLDER 4.0 TERMINAL  4.5 CODE : C  3.8 CODE : T
CODE	AU	C	B	BR								
A	0.6	0.8	1.0	1.2								